

HANDLE SHOWN IN LATCHED POSITION
HANDLE MAY BE TURNED CLOCKWISE
TO OPEN. HATCH MAY BE OPENED
FROM INSIDE OR OUTSIDE.

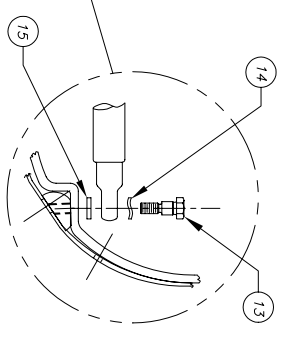
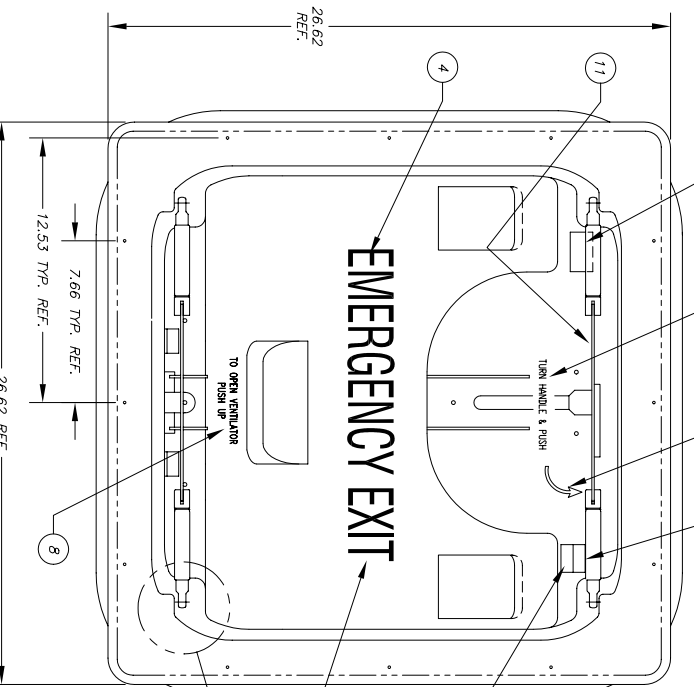
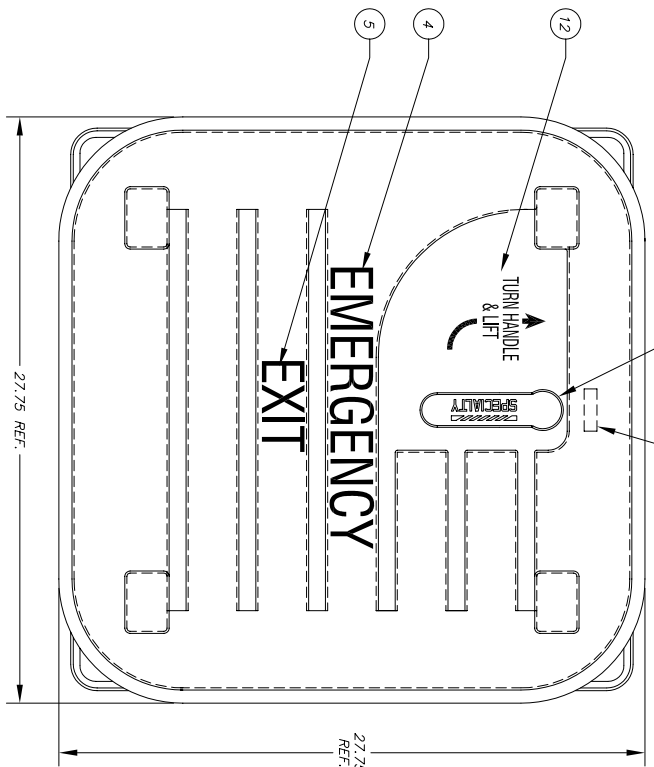

- NOTES**
- HATCH MEETS OR EXCEEDS FMVSS 217 FOR SCHOOL BUS APPLICATIONS WITH EXCEPTION OF SS.5.3.C.
 - HATCH MEETS OR EXCEEDS FMVSS 302 FOR FLAMMABILITY OF INTERIOR MATERIALS.
 - HOLE CUT-OUT FOR HATCH INSTALLATION TO BE 23.5" X 23.5" WITH 4.0" RADIUS CORNERS WITH A 7/8" MINIMUM CLEARANCE ON THE TOP METAL SHEET TO BE FREE OF FASTENERS OR OTHER DISCONTINUITIES.
 - CONTINUOUS LOOP ADHESIVE MOUNT GASKET PROVIDED WITH HATCH TO BE INSTALLED ON TOP METAL SHEET CUT-OUT WITH SPLICE LOCATED AT REAR OF HATCH.
 - HATCH SUPPLIED WITH "EMERGENCY EXIT" & OPERATING INSTRUCTIONS ON INSIDE OF HATCH LID.
 - SWITCHES SUPPLIED WITH 24" LONG LEADS.
 - HATCH LID MATERIAL: ASA CAPPED ABS, INTERIOR FRAME: TPO.
 - HATCH MEETS OR EXCEEDS CANADIAN STANDARDS ASSOCIATION STANDARD D250-07 FOR SCHOOL BUSES.

ITEM	PART NO.	QTY	DESCRIPTION
1	009343	1	LID ASSY, WHI, STATIC VENT, 200"R
2	009320	1	ASSY, TRIM RING, PROLO
3	009332	1	GASKET, PROLO
4	008715	2	DECAL, "EMERGENCY" BLACK
5	008716	2	DECAL, "EXIT" BLACK
6	008765	1	DECAL, MODEL NO.
7	008714	1	DECAL, SPECIALTY
8	009349	1	DECAL, "TO OPEN VENTILATOR"
9	008718	1	DECAL, "TURN & PUSH" RED
10	008548	1	DECAL, ONE WAY INSIDE ARROW, RED
11	009341	1	DECAL, PROLO "TO CLOSE..."
12	009333	1	DECAL, "TURN HANDLE & LIFT"
13	008846	2	SCREW, 1/4-20 X 1 HEX HD SHOULDER
14	008905	2	WASHER, 3-WAVE
15	008892	2	WASHER, 1/4 ID FLAT

9245-0301	ENGLISH / WHITE / NO ALARM
9245-G301	ENGLISH / GRAY / NO ALARM
9245-0300	ENGLISH / WHITE
9245-G300	ENGLISH / GRAY
9245-0300D	PROLO HATCH, 200"R, WHITE, NO VENT W/ HANDLE, W/ ALARM

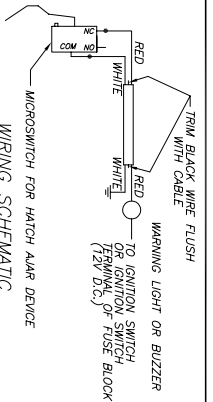

SPECIALTY MANUFACTURING INC.

10200 PINEVILLE ROAD
P.O. BOX 790
PINEVILLE, NC 28134

SCALE: 1" = 1"

TOLERANCES (UNLESS NOTED):
DIMENL: .XX ± .010 XX ± .03
ANGLES: ± 1°

THE INFORMATION CONTAINED HEREIN IS THE PROPERTY OF SPECIALTY MANUFACTURING INC. AND IS TO BE USED FOR THE MANUFACTURE OF THE PARTS IDENTIFIED THEREIN. ANY OTHER USE WITHOUT THE WRITTEN PERMISSION OF SPECIALTY MANUFACTURING INC. IS EXPRESSLY PROHIBITED.

DATE: 02/15/02
J. ENLOE
DRAWING NO. 9245-0300D