

ITEM QTY	P/N	DESCRIPTION
1	006110	6 SERIES BASE ASSEMBLY
2	000980	BLADE, HI-INT. W/ STROBING LEDS

REV.	DATE	BY	NOTES

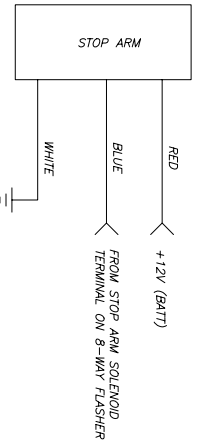
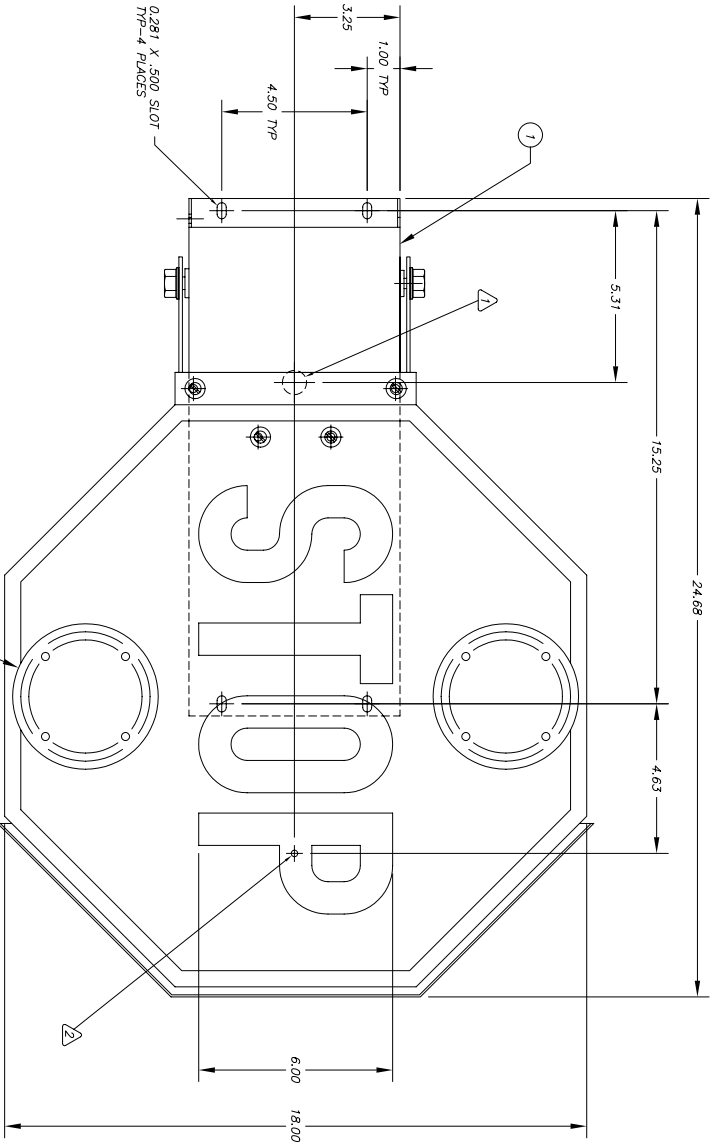

**NOTES**

- 1 HARNES LOCATION. STANDARD WIRING INCLUDES 16 GA LEADS 3 FEET IN LENGTH.
- 2 INSTALL WINDGUARD FASTENER AFTER TIGHTENING BASE FASTENERS. DIMENSIONAL DATA ONLY. CONSULT MANUFACTURER FOR SPECIFIC MODEL REQUIREMENTS.
- 3 ALL MODELS TO INCLUDE WINDGUARD (SHOWN).
- 4 INSTALLED THICKNESS: 3.5"
- 5 MAXIMUM PROTRUSION AT FULL OPEN POSITION: 23.5" (MEASURED FROM BACK MOUNTING SURFACE OF UNIT).
- 6 WIRE IDENTIFICATION: RED - STOP ARM POWER  
BLUE - STOP ARM ACTIVATION  
WHITE - GROUND

**SPECIALTY MANUFACTURING INC.**  
 10200 PINEVILLE ROAD  
 P.O. BOX 790  
 PINEVILLE, NC 28134

DRAWN BY: GCM DATE: 1/15/07  
 MATERIAL: SEE BOM  
 FINISH: SEE BOM  
 SCALE: 1 OF 1 SHEET SIZE B  
 TOLERANCES (EXCEPT AS NOTED)  
 DECIMAL: .XXX ± .010 XX ± .03  
 ANGULAR: ± 1°

THE INFORMATION CONTAINED HEREIN IS THE PROPRIETARY DATA OF SPECIALTY MANUFACTURING INC. AND IS NOT FOR DISSEMINATION OR DISCLOSURE IN WHOLE OR IN PART FOR ANY PURPOSE OTHER THAN THAT FOR WHICH IS SUBMITTED, EXCEPT AS EXPLICITLY AUTHORIZED IN WRITING BY SPECIALTY MANUFACTURING INC.

DESCRIPTION	STOP ARM - HI-INT, STROBING LEDS
DIRECTORY	C:/ACAD/CUST-DWG
FILE NAME	006980-0
DRAWING/PART NO.	006980-0
REV.	—